

**NEW** larger 8 1/2" diameter hardened chrome pistons

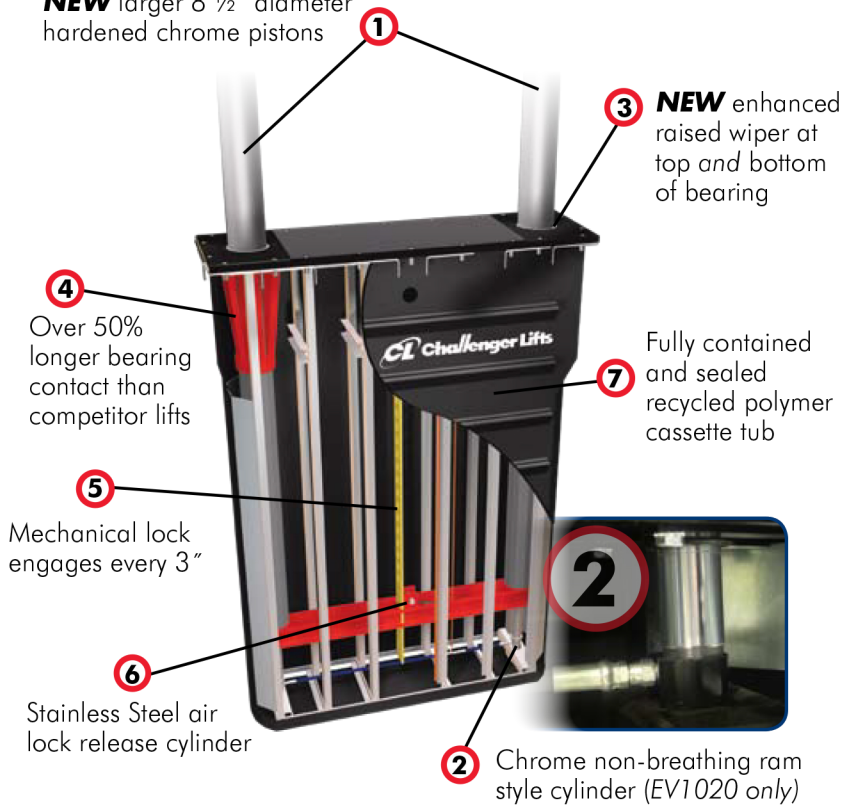

- 1** Provides greater stability under load
- 2** Minimizes water intake and other contamination
- 3** Provides better grease retention and minimizes contaminants from entering into bearings
- 4** Provides maximum stability
- 5** Provides safety and allows techs to work at an ergonomic height increasing productivity and minimize fatigue
- 6** Promotes longer working life with its corrosion resistant design
- 7** Eliminates risk of hydraulic fluid seeping into the ground



The Automotive Lift Institute (ALI) certifies that the EV1020, EV1220, and EV1520 described herein complies with the applicable provisions of the American National Standards ANSI/ALI ALCTV 2006 and are Third Party Validated by the ETL Testing Laboratory.



**4** Over 50% more bearing spread than other competitive models, providing smooth and stable lifting up to 15,000 lbs.

Acetal fabricated bearings bonds the empty space between metal and plastics ensuring more stability to the moving piston to the stable structure.



**EV1020**  
3-stage front and 3-stage rear swing arms

**EV1220**  
2-stage front and rear swing arms with stack adapter kit & (4) frame engaging adapters



**EV1520**  
Heavy-Duty 2-stage drive-over front and rear swing arms with stack adapter kit & (4) frame engaging adapters



Enhanced raised wiper made from thermoplastic polyurethanes (TPU) is resilient to impacts, abrasion, oils and grease.



### Chrome Benefits

- Extends life of pistons
- Highly lubricious
- Ultra hard - harder than steel
- Stands up to high stress contact
- 100 times better wear than steel
- Less prone to abrasion
- Attractive finish
- Low friction

